

Data sheet

Hydraulic data

Maximum operating pressure P_N	6 bar
Pressure port	G 1
Min. fluid temperature T_{min}	5 °C
Max. fluid temperature T_{max}	35 °C
Min. ambient temperature T_{min}	0 °C
Max. ambient temperature T_{max}	40 °C

Motor data

Mains connection	1~230 V, 50 Hz
Voltage tolerance	±10 %
Shaft power $P_2(Q=\max.)$ of selected impeller * number of pumps	750 W
Rated power P_2	0.75 kW
Rated current I_N	5 A
Rated speed n	2850 1/min
Insulation class	F
Protection class	IPX4

Materials

Pump housing	Cast iron
Impeller	Stainless steel
Shaft	Steel
Shaft seal	BQ1PFF
Gasket material	NBR

Installation dimensions

Pipe connection on the suction side DNs	G 1
Pipe connection on the pressure side DNd	G 1

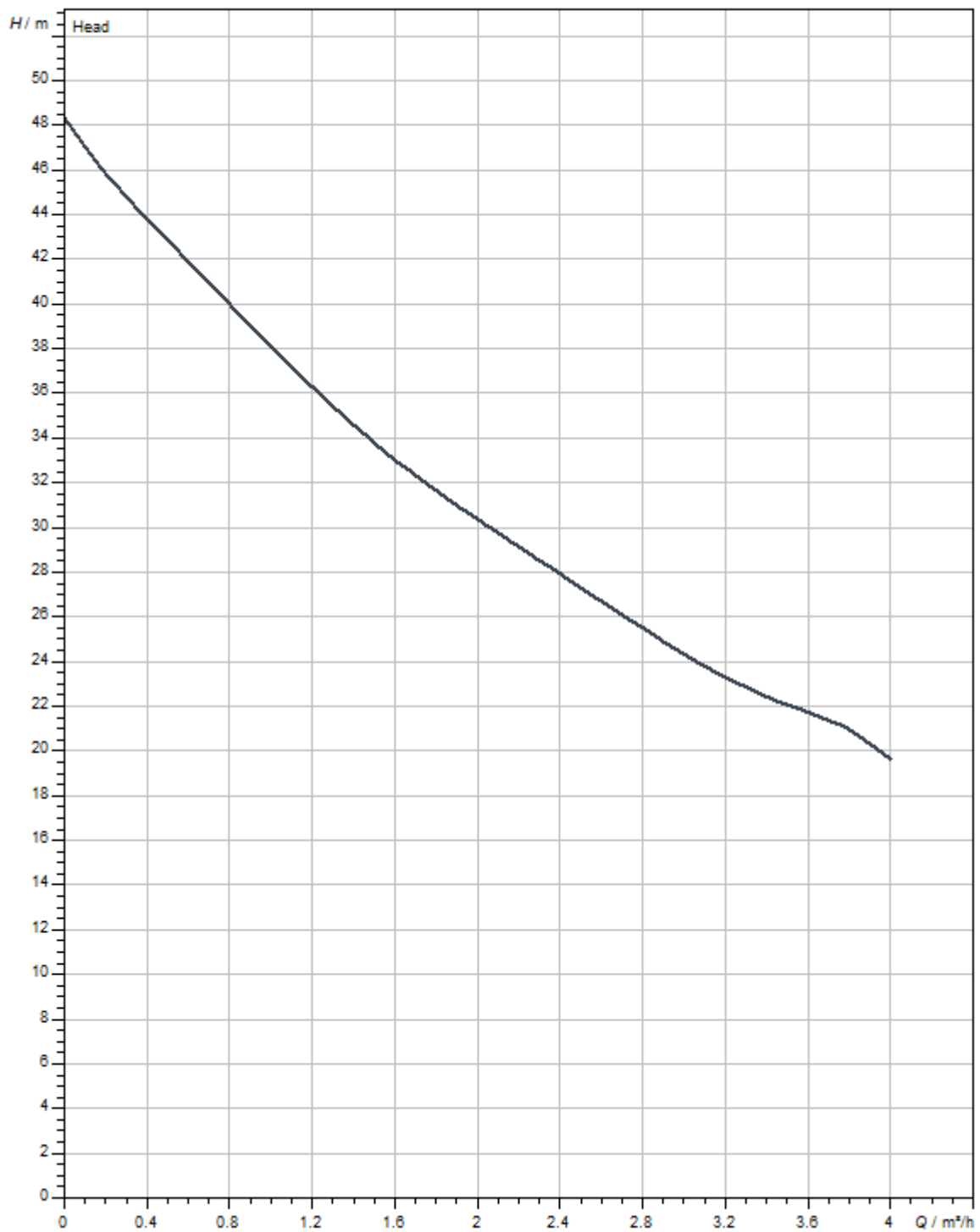
Pump curves

Dimensions and dimensions drawings

Wilo-INITIAL JET 4-4

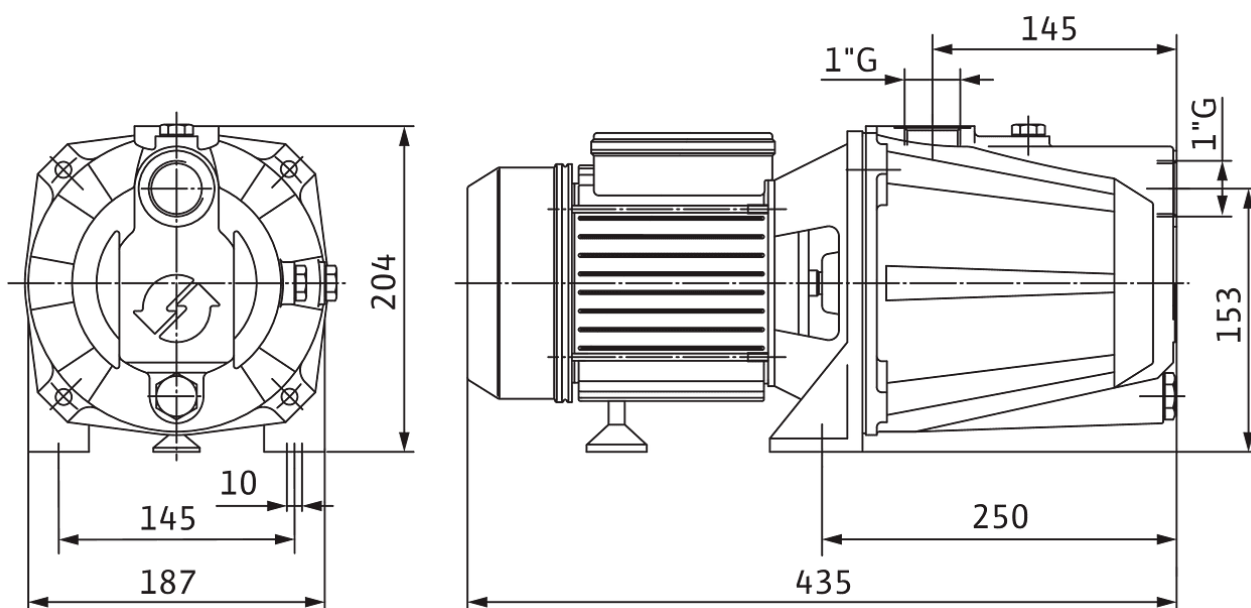

Ordering information

Product data

Brand	Wilo
Product description	Initial JET 4-4
Article number	4168023
EAN number	4048482250854
Colour	green/black
Minimum order quantity	1
Date of sales availability	2018-09-01

Packaging

Number per layer	1
Packaging property	Transport packaging
Packaging type	Cardboard box
Pieces per pallet	1

Dimension, weight

Length with packaging	453 mm
Length <i>L</i>	435 mm
Height with packaging	241 mm
Height <i>H</i>	204 mm
Width with packaging	201 mm
Width <i>W</i>	187 mm
Gross weight, approx. <i>m</i>	15.9 kg
Net weight, approx. <i>m</i>	15 kg

Tender text

Self-priming single-stage jet pump for water supply, irrigation and rainwater utilisation. Self-priming up to 7

m. Electrical connection via a terminal box. All parts that come into contact with fluids are corrosion-resistant.

Materials

Pump housing	Cast iron
Shaft	Steel
Shaft seal	BQ1PFF
Gasket material	NBR
Impeller	Stainless steel

Operating data

Fluid media	Water
Min. fluid temperature T_{\min}	5 °C
Max. fluid temperature T_{\max}	35 °C
Maximum operating pressure p	6.0 bar
Pressure port	G 1
Max. ambient temperature T_{\max}	40 °C

Motor data

Mains connection	1~230 V, 50 Hz
Voltage tolerance	±10 %
Rated power P_2	0.75 kW
Rated current I_N	5 A
Rated speed n	2850 1/min
Insulation class	F
Protection class	IPX4

Installation dimensions

Pipe connection on the suction side DN_s	G 1
Pipe connection on the pressure side DN_d	G 1

Information for order placements

Net weight, approx. m	15 kg
Brand	Wilo
Product description	Initial JET 4-4
Article number	4168023